

// CONNECTIONS IN TOP FORM.

One partner, double the advantages: Paul Hafner not only impresses with its leading expertise in tool-making – but also in the series production of your innovative stamped and formed parts. Thanks to the seamless linking both areas, you benefit from our exceptionally fast and efficient processes. This is how we ensure that your project is a complete success - from the first tool to the finished assembly.

New development: Tube parts

Deep drawing in combination with cold forming = tube technology

Drawn tube

- // High-strength connection
- // Repairable (Helicoil)
- // Cost reduction through fewer work steps
- // Weight saving
- // With or without thread

High work hardening = high thread strength
Thread from M6 to M14 (screw 12.9)

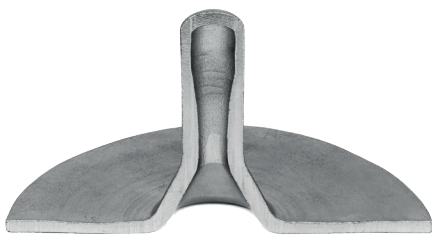
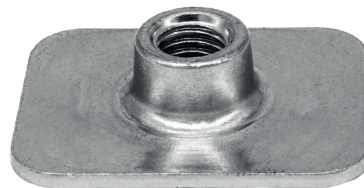

New at Hafner: Laser tube parts

Laser welding in combination with cold extrusion = laser tube technology

The alternative to the drawn tube is the laser tube. Here, clever cold-formed parts (tube) are combined with a formed part and laser-welded. This allows thin components to be combined with solid tubes.

Laser tube

- // High-strength connection
- // Repairable (Helicoil)
- // Weight saving through smaller combinations
- // With or without thread

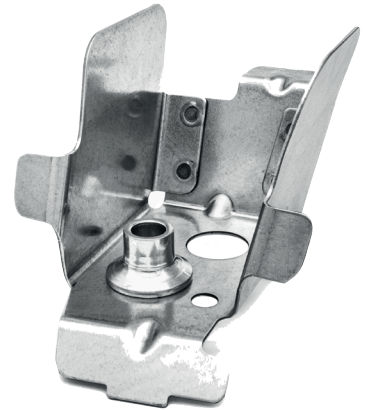
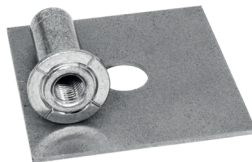
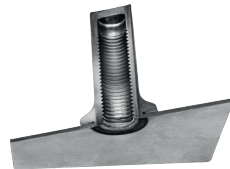
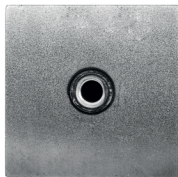

TOP QUALITY

The certification of our quality management in accordance with ISO 9001 and IATF 16949 for the high requirements in the automotive industry confirm our strict quality standards. We leave nothing to chance when it comes to environmental management and work in accordance with the internationally valid ISO 14001 standard.



YOUR CONTACT PERSON

Matthias Kaufmann
Head of Sales

Phone +49 (0)7426 / 6006 - 65
Mail anfrage@paul-hafner.de

PAUL-HAFNER.DE